

NO. PROCESSED	DATE	06/21
	NEW DESIGN	TJG
	SHEET CHECKED	DEM
AS BUILT DETAILS	DATE	
STATION	DATE	
DESCRIPTION	DATE	

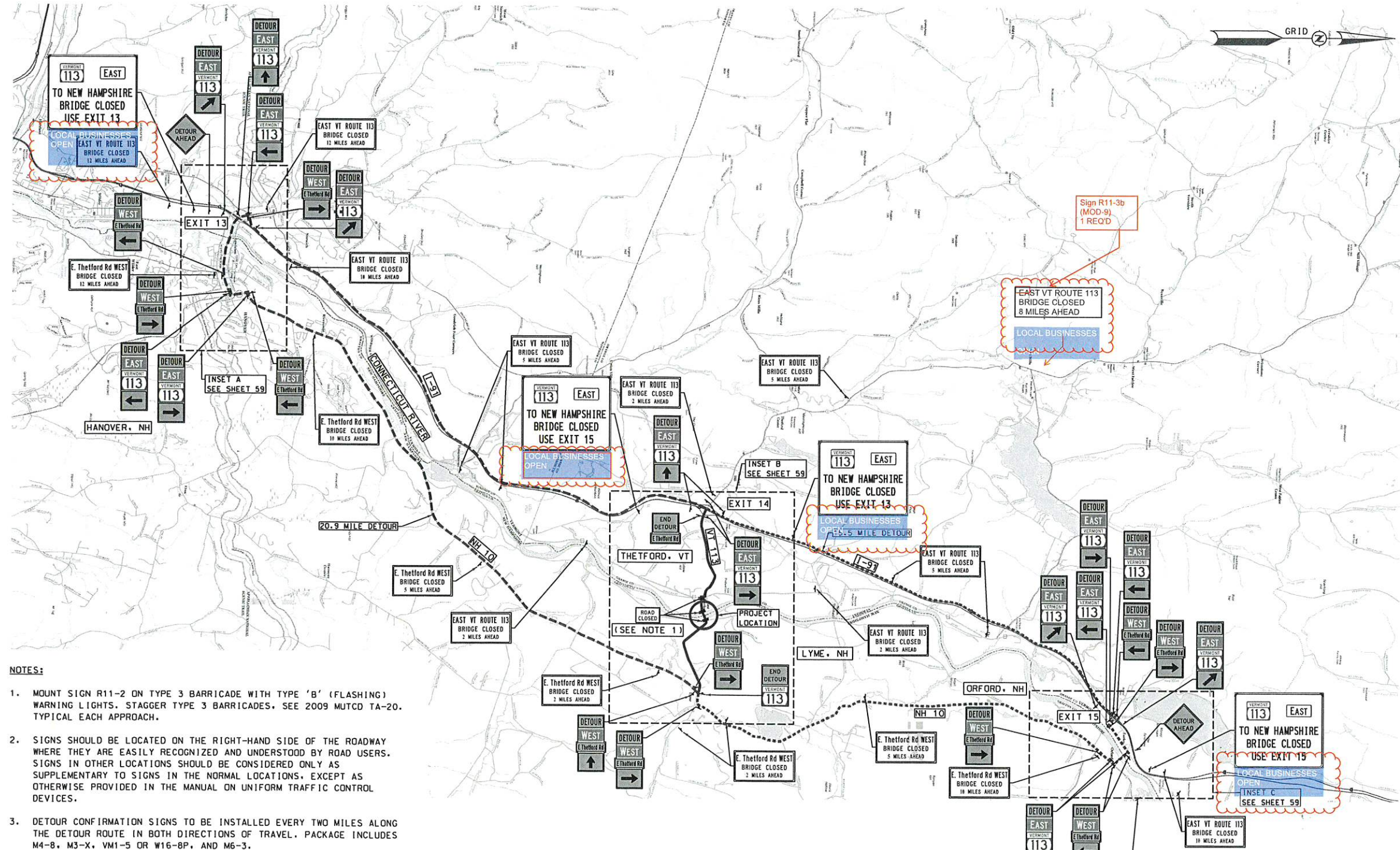

**NOTES:**

1. MOUNT SIGN R11-2 ON TYPE 3 BARRICADE WITH TYPE 'B' (FLASHING) WARNING LIGHTS. STAGGER TYPE 3 BARRICADES. SEE 2009 MUTCD TA-20. TYPICAL EACH APPROACH.
2. SIGNS SHOULD BE LOCATED ON THE RIGHT-HAND SIDE OF THE ROADWAY WHERE THEY ARE EASILY RECOGNIZED AND UNDERSTOOD BY ROAD USERS. SIGNS IN OTHER LOCATIONS SHOULD BE CONSIDERED ONLY AS SUPPLEMENTARY TO SIGNS IN THE NORMAL LOCATIONS, EXCEPT AS OTHERWISE PROVIDED IN THE MANUAL ON UNIFORM TRAFFIC CONTROL DEVICES.
3. DETOUR CONFIRMATION SIGNS TO BE INSTALLED EVERY TWO MILES ALONG THE DETOUR ROUTE IN BOTH DIRECTIONS OF TRAVEL. PACKAGE INCLUDES M4-B, M3-X, VM1-5 OR W16-8P, AND M6-3.
4. WHEN EXISTING ROUTE MARKER ASSEMBLIES ARE LOCATED AT INTERSECTIONS OR ALONG THE DETOUR ROUTE, THE DETOUR ROUTE MARKER ASSEMBLIES SHALL BE INSTALLED ADJACENT TO EXISTING ROUTE MARKER ASSEMBLIES.
5. SEE TEMPORARY SIGN TEXT LAYOUT FOR SIZING OF SIGNS ON THE INTERSTATE (I) OR SECONDARY ROADS (S).

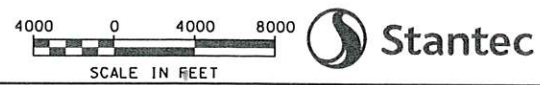

STATE OF NEW HAMPSHIRE			
LYME, NH & THETFORD, VT			
DEPARTMENT OF TRANSPORTATION • BUREAU OF HIGHWAY DESIGN			
<b>DETOUR PLAN (1 OF 2)</b>			
DGN	STATE PROJECT NO.	SHEET NO.	TOTAL SHEETS
14460DETO1	14460	58	67